

Dimex K60 Casement Door with Single Sash

●Glass Configuration

Table1

Glazing Bead	Gasket 650500	Gasket 650400	Gasket 650300
620200	4mm Glass	5mm Glass	6mm Glass
621100	17mm Glass	18mm Glass	20mm Glass
620100	19mm Glass	20mm Glass	21mm Glass
622800	24mm Glass	25mm Glass	26mm Glass
621600	30mm Glass	31mm Glass	32mm Glass

●Accessories

Table3

No.	Name & Art. No.	Remark
1	Glazing Wedge 1mm 230300	
2	Glazing Wedge 2mm 230400	
3	Glazing Wedge 3mm 230500	
4	Gasket 650100	

●Assembly Parts

Table2

No.	Name & Art. No.	Remark
①	60 Casement Door Frame 210500	
②	60 Outward Door Sash 211000	
③	Glazing Bead 220100	The Glazing Beads in Table1 are Optional
④	Gasket 650200	The Gaskets in Table1 are Optional
⑤	Glazing Wedge 230100	
⑥	Reinforcement 664400	

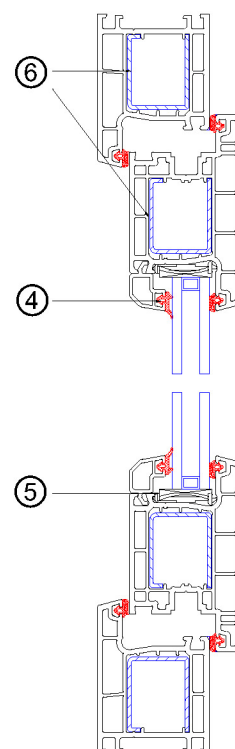
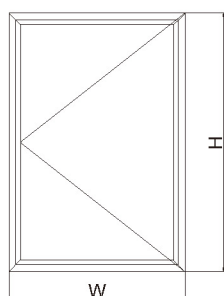

Vertical Assembly Drawing

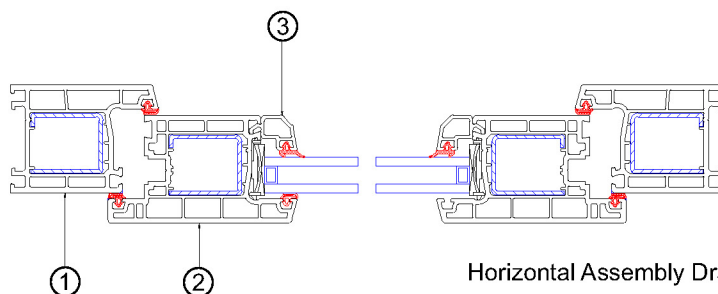

Horizontal Assembly Drawing

Version:12-3/15

Tel: +86 512 53563 223/227

Fax: +86 512 53563201

<http://www.dimex.com.cn>e-mail: export@dimex.com.cn

Komfort 60 Series

Door Assembly Drawing 10